

Town of Plymouth Data Sheet

Station:	Point 19	Taylor Ave (Bartlett Pond)		NGS PID#		ID#	
Town:	Plymouth		Quad: man				
NAD83	Northerly	Easterly	NAD 27	Northerly	Easterly		
(Survey Ft)	2800403.42551	913251.20847	(Survey Ft)	339733.83601	856949.43422		
(meters)	853564.67122	278359.52506	(meters)	103551.0803	261198.7099		
						Order	
Elevation	Vert. Datum f/m	Order	Stamping:	19			
NAVD88	9.803/2.988		Sketch	See Book			
NAVD29	10.64/3.244		Recov. Date:	Oct 30, 2002 Jan 17, 2006			
Marked by:	Iron Rod						
Description:	3' Iron Rod set.						
Reference Marks:							
Azimuth Data:							
Geodetic:	<pre> NGS OPUS SOLUTION REPORT ===== USER: rfirth@townhall.plymouth.ma.us DATE: January 18, 2006 RINEX FILE: 5037017p.06o TIME: 13:15:57 UTC SOFTWARE: page5 0601.10 master11.pl START: 2006/01/17 15:25:00 EPHEMERIS: igul3582.eph [ultra-rapid] STOP: 2006/01/17 19:54:00 NAV FILE: brdc0170.06n OBS USED: 10476 / 10552 : 99% ANT NAME: TRM33429.00+GP NONE # FIXED AMB: 45 / 45 : 100% ARP HEIGHT: 1.606296 OVERALL RMS: 0.010(m) REF FRAME: NAD_83(CORS96)(EPOCH:2002.0000) ITRF00 (EPOCH:2006.0458) X: 1582028.181(m) 0.005(m) 1582027.476(m) 0.005(m) Y: -4481231.371(m) 0.007(m) -4481229.928(m) 0.007(m) Z: 4239684.053(m) 0.007(m) 4239683.979(m) 0.007(m) LAT: 41 55 42.69360 0.003(m) 41 55 42.72637 0.003(m) E LON: 289 26 41.19717 0.005(m) 289 26 41.18916 0.005(m) W LON: 70 33 18.80283 0.005(m) 70 33 18.81084 0.005(m) EL HGT: -25.129(m) 0.009(m) -26.366(m) 0.009(m) ORTHO HGT: 2.988(m) 0.027(m) [Geoid03 NAVD88] UTM COORDINATES STATE PLANE COORDINATES UTM (Zone 19) SPC (3800 RI) Northing (Y) [meters] 4643010.129 52407.611 Easting (X) [meters] 371054.372 111108.626 Convergence [degrees] -1.03934762 0.08832878 Point Scale 0.99980460 0.99999527 Combined Factor 1.00008022 0.99999602 US NATIONAL GRID DESIGNATOR: 19TCG7105443010(NAD 83) </pre>						

To convert meters to US survey feet
Multiply by 3.280833333

Grid Azimuth:	

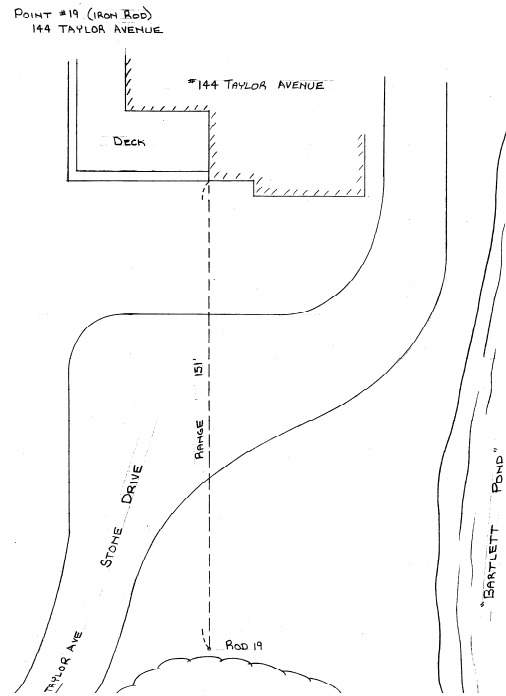

To convert meters to US survey feet
Multiply by 3.280833333